

OPERATING INSTRUCTIONS FOR THE CHOCOLATE MILK HEATER **(Supplement of the operating instructions for the milk heater)**

This chocolate milk heater, HCM, is a variant of the milk heater HM. Therefore first read the instructions of the milk heater, then this supplement.

THE MAIN DIFFERENCES ARE:

- The cover has no dipstick.
- A mixer and a insert disc.
- At the bottom of the inner container is an indentation, in which the insert disc and the mixer fit.

OPERATION WITH MIXER

- Put the insert disc (2) and mixer (1) right into place (3).
- Thereafter pour the chocolate milk into the container.
- Turn the heater on. Now the mixer will stir the chocolate milk automatically.
- Turn the adjustment knob (fig. 1, 7) at the desired temperature.
- Turn the heater off by the switch when it is empty.

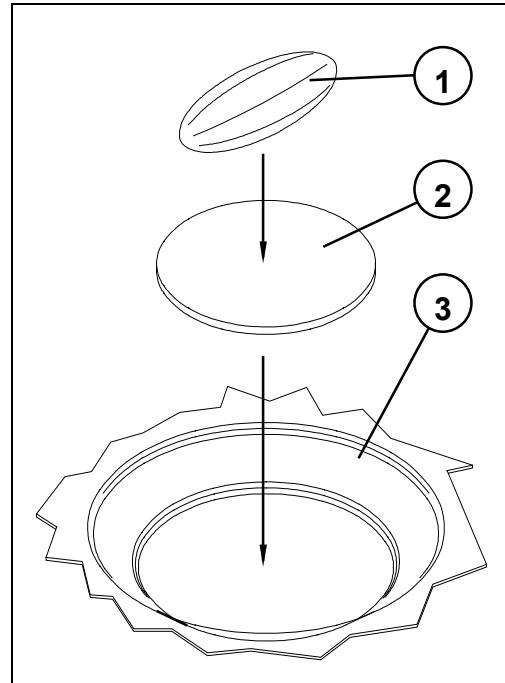

700.403.144 C